

## May 10th in Shamokin

This Saturday is the day for Division 11's Spring mini-convention. The Lower Anthracite Model Railroad Club has opened their doors to us and will be our host for the day. The club boasts the largest model railroad in Pennsylvania at 3,475 square feet! The scenery is 100% complete. The layout models the former Reading Railroad that served the local area. The club has modeled many of the local landmarks and historical buildings and placed them at various areas of the layout. There is an elevated control booth and even closed circuit TV's to help keep the trains in sight. The operators use CTC to control the movement of the trains and DCC to run them.

The club also has an HO modular layout, an N scale layout, various railroad artifacts, a small kitchen and meeting rooms.

In the Fall of 1996, Model Railroader Magazine was there and photographed the layout and interviewed many of the members. The layout will be featured in a future issue. This makes a great preview.

Scheduled for the mini-convention is the Election of Directors, clinics and Modular Clinic 'E' which is on Structure Building and Prototype Weathering.

What time? 9:00am to 3:00pm. Consult the map in this issue for directions to the club.

## Prototype Information and Model Railroad Notes

by Wm. Terry Nesbit

*(We are looking for someone to collect and write this column for our members)*

The Withers Publishing Company, 528 Dunkle School Road, Halifax, PA 17032, (717) 896-3173, (Halifax is located in the northern part of Dauphin County near the Susquehanna River on Rt. 147) has a reference book titled "Norfolk & Western First Generation Diesels", by Paul K. Withers and Robert G. Bowers, available for \$48.00 plus \$5.00 shipping.

Tenshodo still has a model railroad shop in Ginza, Tokyo, Japan. The store has a limited supply of stocked parts as well as

*(Cont'd on Page 4)*

## Coming Events

**May 10, 1997:** Susquehanna Division 11 Spring Mini-Meet, Lower Anthracite Model Railroad Club, 2nd floor of the Community Center, Shamokin, PA.

**May 23-25, 1997:** Mid-Eastern Region Spring Convention, Land O' Sky Railfest '97, Joint Southeastern/Mid-Eastern Convention, Asheville Radisson Hotel, Asheville, NC. Convention Info: 1-800-333-3333 or Henry Danis 864-576-2614

**June 15, 1997:** York-Hanover Train Meet, Porters Fire Hall, Porters, PA, 9am to 2 pm. Info: 717-632-3157

**June 15, 1997:** Harrisburg - Marysville, PA Train Meet, Pennsylvania Rails 5th Annual Almost Summer, Marysville Lions Club Park Building, Marysville, PA, 9 am to 3 pm, adults \$4, under 12 free. Dealers: \$20 per table. Info: Michael Yingling, 717-540-1688

**July 27 to August 2, 1997:** NMRA National Convention, Madison, WI.

**August 9, 1997:** Susquehanna Division 11 Summer Mini-Meet, Nittany Valley Model Railroad Club, Bellefonte, PA and the Clinton Central Model Railroad Club, Castanea, PA.

**September 14, 1997:** York-Hanover Train meet, Porters Fire Hall, Porters, PA, 9 am to 2pm. Info: 717-632-3157

**September 20-21, 1997:** Planes, Trains, & Automobiles Transportation Show, The Mid Atlantic Air Museum, Reading Regional Airport, 11 Museum Drive, Reading, PA 19605. 9am to 5pm Sat. and Sun.

**October 4, 1997:** Harrisburg - Marysville, PA Train Meet, Pennsylvania Rails Annual Octoberfest, Marysville Lions Club Park Building, Marysville, PA, 9 am to 3 pm, adults \$4, under 12 free. Dealers: \$20 per table. Info: Michael Yingling, 717-540-1688

**November 7-9, 1997:** Mid-Eastern Region Fall 1997 Convention, "Brandywine Junction 97", hosted by the Philadelphia Division, Chadds Ford Ramada Inn, Routes 202 and 1, 1110 Baltimore Pike, Glen Mills, PA. Info: Registrar, John Nawn, P.O. Box 741, Paoli, PA 19301 Ph: 610-461-8644

**November 22, 1997:** First Annual Susquehanna Division 11 Modular Meet, Zembo Temple, Harrisburg, PA.

**November 26, 1997:** Conewago Valley Model Railroad Club Annual Auction, New Oxford Fire Hall, New Oxford, PA 7 pm until ?

*(Cont'd on Page 2, Events)*

## Division 11 Staff

**Superintendent:** Terry Nesbit, 5760 Union Deposit Road, Harrisburg, PA 17111-4708. Ph. 717-657-9476

**Asst. Superintendent:** Brian C. Brandt, 337 Bracken Drive, Lancaster, PA 17601. Ph. 717-560-9542 or 717-581-0647 email: BrianB4717@aol.com or trains@redrose.net

**Chief Clerk:** Paul F. Tice, 1709 West Market Street, York, PA 17404. Ph. 717-843-9572

**Newsletter Editor:** Don Yingling, 2420 Heather Road, York, PA 17404-4383. Ph. 717-764-2676 email: TrolleyNut@aol.com

**Achievement Program Chairman:** Terry Nesbit, 5760 Union Deposit Road, Harrisburg, PA 17111-4708. Ph. 717-657-9476

**Scouting Merit Badge for York & Adams Counties:** Alan Frame, 2430 Opal Road, York, PA 17404. Ph. 717-767-4998

**Scouting Merit Badge for Cumberland, Perry, & Dauphin Counties:** David C. Buchanan, 118 Forest Drive, Camp Hill, PA 17011-8304. Ph. 717-737-7029

**Scouting Merit Badge for Lancaster, Lebanon, & Berks Counties:** Jeremy Griffith, 352 Broad Street, Terre Hill, PA 17581. Ph. 717-445-5183

**Division All-Scale Module Coordinator:** Mel Agne, 48 Oakwood Drive, Delta, PA 17314. Ph. 717-862-3937

**Division Membership Chairman:** Jim Atkinson, 120 Colebrook Road, Elizabethtown, PA 17022. Ph. 717-367-5626

*Susquehanna Sidetracks* is the Official Publication of the Susquehanna Division 11 of the Mid-Eastern Region of the National Model Railroad Association, Inc. Dues are \$2.00 per year payable to "Susquehanna Division 11". Remit dues to the Chief Clerk. Dues include subscription to the Division newsletter. Deadlines for submissions to the Newsletter are the first day of each quarter: January 1 for Jan-Mar; April 1 for Apr-Jun; July 1 for Jul-Sep; and October 1 for Oct-Dec.

## Logo Contest Results

The fourth logo received the vast majority of the votes received by the 28th of February. The results are: Logo 1, 3 votes; Logo 2, 1 vote; Logo 3, 1 vote; and Logo 4, 8 votes. Division membership cards are being developed and should be available by the Spring meet in Shamokin. *Wm. Terry Nesbit*

## Why?

Why are there Braille dots on the keypad of the Drive-up ATM?

Why are there interstate highways in Hawaii?

## Super's Corner

*By Wm. Terry Nesbit*

Spring is here and Susquehanna Division 11 has already held 4 divisional Modular Clinics this year. These clinics have been well attended. For those of you who missed the Modular Clinic in Mechanicsburg on the 1st of February, due to the mailing of the January issue, this clinic will be offered again at Jack Kennedy's home in Mechanicsburg on the 12th of July from 10:00 am to 2:00 pm.

Speaking of clinics, if you are interested in giving one or more, please drop me a note or send an email to Brian Brandt, his addresses are in the staff roster. Those individuals giving clinics can earn credit towards the "Author" and "Association Volunteer" areas of the Achievement Program.

Recently, information has come to my attention from the National personnel, the NMRA has an estimated 55,000 to 65,000 individuals participating in NMRA activities in one form or another. How can this be if there are only 24,000 to 25,000 NMRA members on the books? The answer can be found at the regional and divisional levels. All those Subscribers, Associates and/or Friends, who are receiving information and/or attending events as guests of our regular members. We, as members of the NMRA, MER, and Susquehanna Division 11, can not afford to support the non-funded activities of the 30 to 40 thousand model railroad Subscribers, Associates, or Friends as non-members.

Susquehanna Division 11 is guilty of promoting this trend as approximately 46% of our current mailing of the *Susquehanna Sidetracks* is to Subscribers. These individuals are benefiting and feeding on the information and/or programs of our division, the MER, and the NMRA without paying their own way.

I, as your Superintendent, am proposing an additional change to our By-Laws. This change is to the status of "Subscribers" who choose not to belong to the MER and the NMRA. The Susquehanna Division 11 will require Subscribers to be sponsored by a Regular Member and become Regular Members within 1 year of their Subscriber status. This status will be offered once per individual addressee and/or organization. Those Subscribers who after 9 months to 1 year, who do not choose to become Regular Members, will be dropped from the division mailing list and will lose their ability to attend division events.

My personal feelings as a member of the NMRA and MER since 1964 are: "...Since the Susquehanna Division 11, MER, NMRA is offering monthly divisional educational model railroad events, the Subscriber has been provided ample opportunities to decide if they want to support the Susquehanna Division 11, MER, and the NMRA in their pursuit of the various aspects in the Hobby of Model Railroading..."

For the Good of the Order, have a rail fun day and watch out for those trains...

## Editor's Notes

What a month! I am writing this on the 29th of April. Articles and info came in late this month for the newsletter and I am involved with a project for my son's school which includes a lot of art work on name badges and the work has to be different for each 3 to 8 badges. Some how I am squeezing this all together. So my apologies for this mailing being so close to the May 10th meet at Shamokin.

I had planned to attend but my wife could not get vacation that day so I will be here around York that day.

Did you here that the NMRA dues are going up from \$30 per year to \$32 per year? It is an inflationary thing pushing them up. At first I thought that enough is enough and I won't renew. I have been a member for over 25 years and I decided that I am not quitting now. I know I would miss all the friendships and the MER conventions that I attend. Some how when the weather gets to that certain time of the season it seems like it is convention weather and the urge would be too strong not to go. Does that make sense?

Speaking of dues, I know the request has not been formally made so I am going to stand on my soapbox and say, "If you are going to send in your MER and NMRA dues through the division then please include the 64 cents postage and be sure that your renewal applications are filled out completely." This has become a real headache for bookkeeping and keeping track of who is doing what.

One more quick note before I leave. The YH&F is completely moved, some benchwork up, all switch machines are install in the Frederick staging yard and I am working on wiring it to get that part running.

So ... Keep those trains running and enjoy the great Spring weather. *Don, Editor*

## NMRA Achievement Program

*by Wm. Terry Nesbit, AP Chair*

The NMRA has made a significant change in the Judges Score Sheet, effective March 1, 1997. The point structure has been change to reflect the improvements in the manufactured material available to the hobbyist and the wealth of prototype technical research materials now available, compared to that of the mid 1960's when the A.P. was first started. The chart below shows those changes.

	1966 to Feb 1997	March 1, 1997
Construction	40 points	40 points
Detail	25 points	20 points
Conformity	10 points	25 points
Finish & Lettering	25 points	25 points
Scratch Building	25 points	15 points

The emphasis has shifted from scratch building to prototype conformity. So, when you have those contest entries, be sure to have your photos, drawings, and plans available for the judges to review along with your models.

The Susquehanna Division 11 has a new member. His name is Philip Fairman , who presented 2 excellent diesels for judging under the new format. These diesels are both merit award winners. Congratulations Philip! *Wm. Terry Nesbit*

*(I will be trying to get some the new forms from John Johnson , the MER General Contest Chairman, and will try to fill any requests I can for them. Don, MER Model Contest Chairman.)*

## Events *(Cont'd from Page 1)*

**December 7, 1997:** York-Hanover Train Meet, Porters Fire Hall, Porters, PA, 9 am to 2 pm. Info: 717-632-3157

**December 13, 1997:** York, PA Train Meet, Pennsylvania Rails Annual York Meet, York Fairgrounds, York, PA, 9 am to 3 pm, adults \$4, under 12 free, dealers: \$20 per table. Info: Michael Yingling, 717-540-1688

**December 27, 1997:** Susquehanna Division 11 Modular Show, Hershey Medical Center's Children's Hospital Ward. *(Open only to children at the hospital and members with modules to setup).*

## Membership Thermometer

**Current Membership 4/19/97: 103**

### New Members:

Jim Lott, Gardners, PA

Philip B. Fairman, Etters, PA

Thomas H. Hoover, Mechanicsburg, PA

Alex Everhart, York, PA

Ken Banke, Littlestown, PA

### Renewals:

Jim Clay, Mechanicsburg, PA

Donald I. Gross, York, PA

Jim Robinson, Harrisburg, PA

Gale W. Smith, Kempton, PA

William J. Trotman, Reading, PA

Dick Diehm, Kutztown, PA

Philip Mellott, Lititz, PA

Do you need to renew your Division 11 dues? MER? NMRA?

## Prototype *(Cont'd from Page 1)*

used models. Due to the language and time differences, it is best to send a FAX to 011-81-3-3562-1931 or use their Web Site at <http://www.ijnet.or.jp/tenshodo/> (Note: much of the site is in Japanese). Your best bet is to contact Mr. Dirk Start, Tokyo, Japan at FAX 011-81-3-5434-1240. Mr. Start is a fellow model railroader who has "volunteered" to assist other fellow model railroaders and is not associated with the Tenshodo Model Company.

"Weathering with Chalks," by Allen Olsen, is a 45 minute videotape. The models used in this tape are G scale, however, the techniques are appropriate to any scale. The video is available from Digital Images, Inc., P.O. Box 2584, Littleton, CO 80161, Ph. (303) 220-8998 for \$24.95 plus \$3.00 shipping. Note: this video will be used as part of Division 11's Spring mini-meet at Shamokin, PA on May 10th.

Kris Klemick, of Jersey Shore, PA (Lycoming County), who is 17, is planning his model railroad dream layout: the Conrail Corning Secondary Line, which runs through Central Pennsylvania and his hometown. Kris is a skilled structure builder and is looking for assistance from other model railroaders to record as 35 mile section of what the Conrail line looks like today. So, if there are any division members out there who would like to help Kris, please contact him at (717) 398-1536.

January 27, 1997, was the 25th anniversary of the merger of the Norfolk & Western and the Southern railroads to become the Norfolk Southern Railroad.

The Union Pacific Railroad has expanded and improved its "Aztec Eagle" intermodal service to several former Southern Pacific cities, from Mexico to Laredo, Tx.

Conrail and Guilford Rail Systems (CSX), has launched "Down East Express", a direct intermodal rail service linking Waterville, Me to major U.S. markets in Chicago, Kansas City, St. Louis and Atlanta.

The Kansas City Southern Railway Company and GATX, have formed a new joint venture which specializes in railroad rolling stock leases. Initially they will carry 2800 freight cars and 280 locomotives under Southern Capital Corporation LLC.

**Chilled-Out Cargo.** West Coast catalog aficionados are in a state of despair this month (January) following derailment of a freight train carrying bulk mail near Seattle, recently. No one was injured as five freight cars toppled into Puget Sound. At least one rescue worker suffered frost bite while trying to retrieve copies of the latest "Victoria's Secret" catalog from the chilly waters.

## Model in a Minute

by Bob Glatfelter

You have all those beautiful trucks sitting around and no place to show them. Lets get them out on the highway and show them off.

First find a place where they can best be seen. Get out your digging tools and set up some barricades, cones jersey walls, etc.

Bring out your backhoe and front end loader (I use a dremel tool) and dig up a place in the road.

Now you can have lots of activity: men working or watching, machinery working, trucks hauling dirt and rocks and best of all your best big rigs stuck in traffic on the highway where everyone can see them.

If you want to spend some more time on this, you can detail the construction site itself: put in curbs, manholes, etc.

## Event Maps

Starting on Page 6 of this issue is a collection of maps and directions. They include the May 10th event in Shamokin. Please heed of their directions, unless you like following coal trucks and don't mind being late.

The map for Terry Nesbit's home was made up for an earlier event so the directions are from Hershey, but once you know where you are on I-83 you should be all right. Those coming from the North, I-83's Northern terminus is at I-81, so plan accordingly.

The map for the July 19th event at Jack Kennedy's does not have a "lead-in" for directions. I would recommend using Rt 11 and come in south on 114 to downtown Mechanicsburg. From I-83 you would be going west on 11 to get there.

Also included is the maps for the Nittany Valley Club and the Clinton Central Club. Once again, pay particular attention to the notes for Bellefonte parking. These two maps will be included in the next issue, but this is just in case it runs late or if you want to ride the Bald Eagle and Northern Railroad at another time.



# SUSQUEHANNA DIVISION 11 1997 EVENT CALENDAR

**MAY 10: DIVISION 11 SPRING MINI-MEET AT SHAMOKIN**, Lower Anthracite Model Railroad Club, Shamokin Community Center, Independence Street, 2nd Floor above the Library. Largest model railroad club in Pennsylvania, 3475 sq. ft., 100% sceniced. To be featured in a future issue of Model Railroader magazine. **DIRECTOR ELECTIONS, CLINICS, AND MODULAR CLINIC "E"**. Structure building and prototype weathering. 9 am to 3 pm.

**MAY 23-25: MER SPRING '97 CONVENTION IN ASHEVILLE, NC.**

**JUNE 28: MODULAR CLINIC "F"**. Scenery and ballast application.

**Wm. Nesbit's home**, 5760 Union Deposit Road, Harrisburg, Ph. 717-657-9476. 10:00am to 2:00pm.

**JULY 19: MODULAR CLINIC "A" OR "B"**.

**Jack Kennedy's home**, 113 East Maplewood, Mechanicsburg, Ph. 717-766-9522. 10:00am to 2:00pm.

**JULY 27 - AUG 2: NMRA NATIONAL CONVENTION IN MADISON, WI**

**AUGUST 9: DIVISION 11 SUMMER MINI-MEET AT BELLEFONTE AND AT LOCKHAVEN MODEL RAILROAD CLUBS. MODULAR CLINIC "C" AND "D"**. In the morning see the Nittany Valley Model Railroad Club in full operation and after lunch the meeting and clinics will be at the Clinton Central Model Railroad Club, inside a former New Central Railroad Station, located at 15 Logan Avenue, Castanea, PA. Modular Clinic, repeat of "C", basic scenery support, castings and painting and "D", making ground foam scenery materials, water and trees. **Bellefonte and Lockhaven, PA**

**SEPTEMBER 20 & 21: Planes, Trains, and Automobiles Transportation Show** at the Mid Atlantic Air Museum, Reading Regional Airport, 11 Museum Drive, Reading, PA. Show times are 9am to 5pm both days. We will have a table at this show.

**SEPTEMBER 27: MODULAR CLINIC "E" OR "F"**.

**H. Eugene Boll**, 3925 Ridgewood Rd., York, Ph. 717-755-5642. 10:00am to 2:30pm. Joint meeting with Susquehanna Valley Garden Railway Society members.

**OCTOBER 25: MODULAR CLINIC TO CHECK QUALITY STANDARDS OF ALL OPERATING EQUIPMENT AND INDIVIDUAL MODULES NOT CERTIFIED** for the Division Module Show.

**Paul Tice's home**, Box 258-A-3 Moul Road, Thomasville, Ph. 717-225-1688. 10:00am to 4:00pm.

**NOVEMBER 7-9: MER FALL CONVENTION IN PAOLI, PA.**

**NOVEMBER 22: FIRST ANNUAL SUSQUEHANNA DIVISION 11 MODULAR MEET IN HARRISBURG AT THE ZEMBO TEMPLE**. Open to the public for an entrance fee and no charge to Division 11 members. See various local modular layouts in operation. **9:30 am to 4 pm**. (set-up time 6am to 9:30 am... take down time 4 pm to 6 pm)

**NOVEMBER 26: CONEWAGO VALLEY MODEL RAILROAD CLUB AUCTION AT NEW OXFORD**. The Division has a table and 2 or 3 volunteers are needed from 6:30pm to 11pm.

**DECEMBER 6: MODULAR CONSTRUCTION DAY**. Cut all parts

**Robert Troutman's home**, Reading, Ph. 610-926-1138. 10:00am to 2:00pm

**DECEMBER 14: PENNSYLVANIA RAILS TRAIN SHOW AT THE YORK FAIR GROUNDS, MEMORIAL HALL**. The Division has a table and 2 volunteers are needed to help out Don Yingling from 9am to 3pm.

**DECEMBER 27: MODULAR SHOW AT THE HERSHEY MEDICAL CENTER'S CHILDREN'S HOSPITAL WARD**. (Not open to the public or other division members, just children at the hospital).

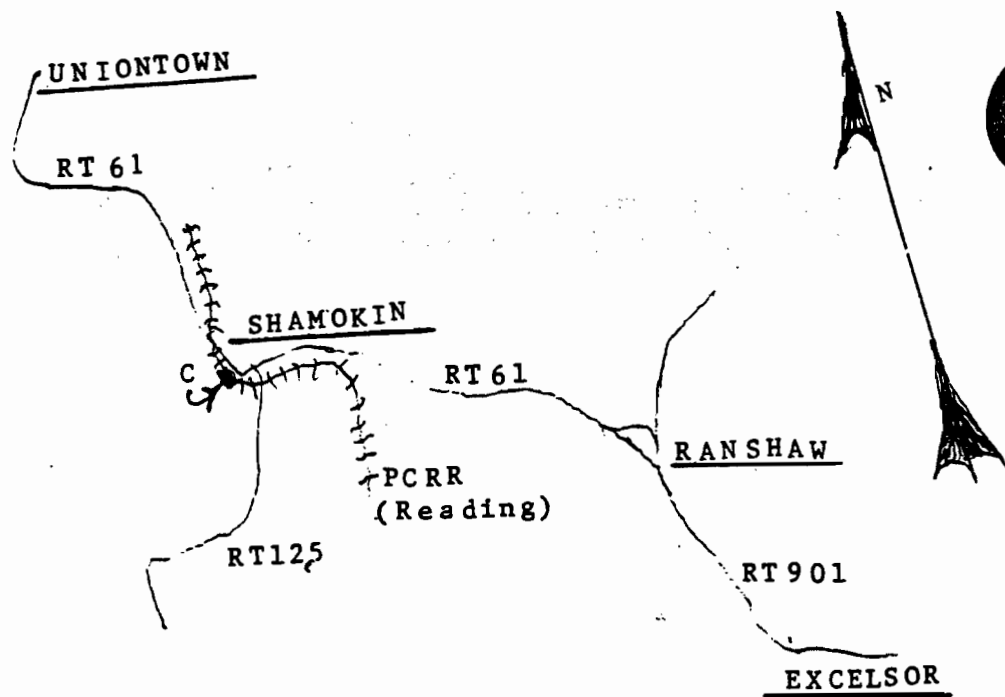

**Lower Anthracite Model Railroad Club**  
**2nd Floor of the Community Center, above the library**  
**Independence Street**  
**Shamokin, PA 17872**  
**Contact: Edward Twigg (717) 648-3987**

**The Lower Anthracite Model Railroad Club is the largest model railroad club in Pennsylvania, covering 3475 square feet of space. This HO scale model railroad is 100% scenicked, has a combination of CTC and DCC controls, has an elevated control booth and Closed Circuit TV cameras to keep the trains in sight for operational purposes. The layout models the former Reading railroad, which served the local area. Many local landmarks and historic buildings are modeled and represented at various areas on the layout. This club also has a small N scale layout, a HO modular layout, railroad artifacts, a small kitchen, and meeting room areas.**

**This layout will be featured in a future issue of Model Railroader, as they were interviewed and photographed in the Fall of 1996.**

**The club is marked with a "C" and an arrow on the map. They are across the street from the US Post Office. Route 61 is recommended if traveling from the East. I-81, Minersville exit, RT 901 to RT 61 is strongly recommended if traveling in from the South or West. RT 125 is not recommended, as it twists and winds around too many blind corners and you must share the road with large coal hauling trucks.**

WM TERRY NESBIT  
5760 Union Deposit Road  
Harrisburg, PA 17111-4708

H 3

NMRA Life #884

Wm. Nesbit's HO/HOn3, Fall River Logging and Mining Company, 230 plus square foot multi-level layout is under construction, with 98% of the track roadbed completed. The layout is designed to capture the look and feel of a Mountain railroad. Designed to have both switching and operational aspects by more than one person. The layout is in a room containing many railroad artifacts and Maintenance of Way equipment from both standard and narrow gauge railroads. Outside are an EBT RR mud flat, and two Fairmont Track Speeders, an M-19 (purchased in 1964) former-MA & PA and S-2E former-C & O.

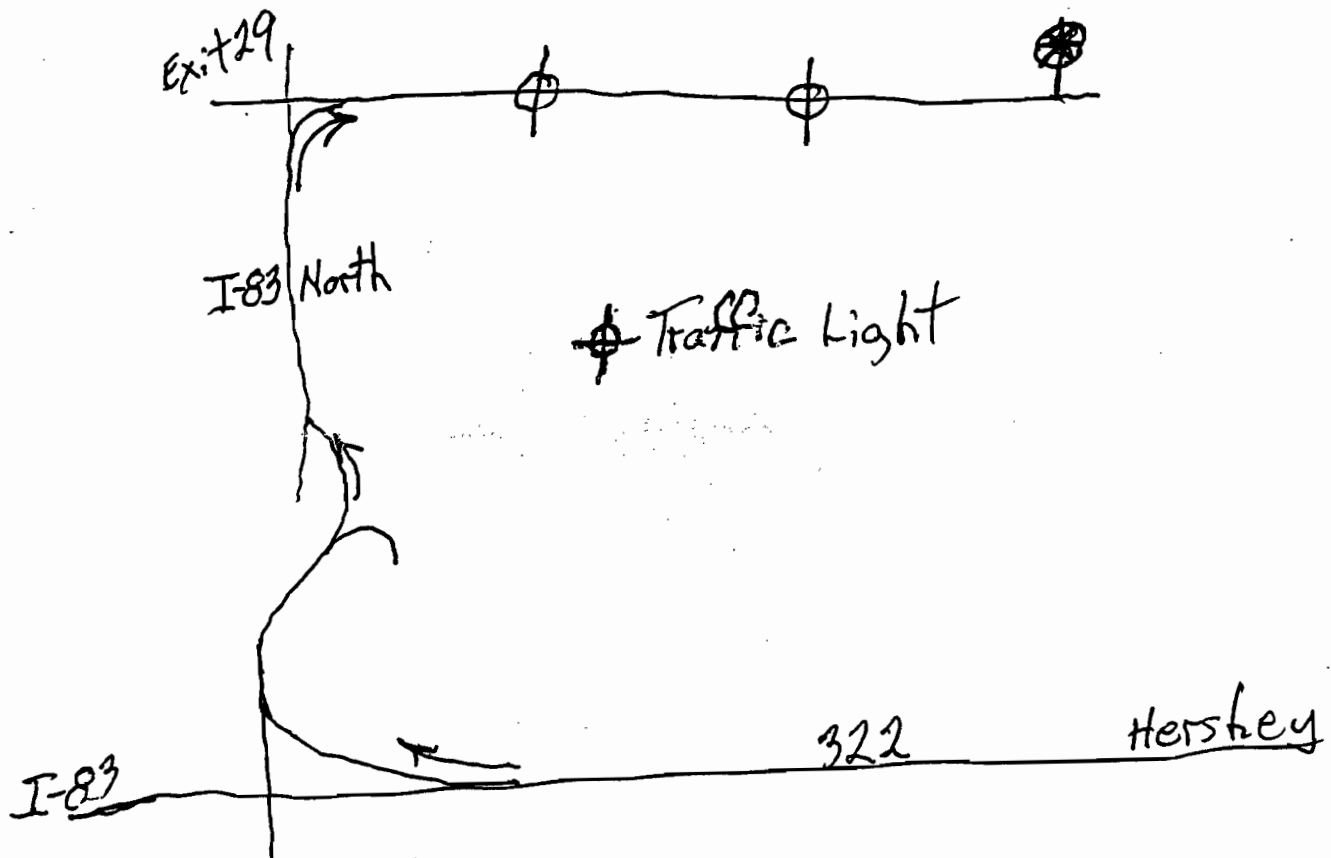

From William Fraley's home:

Go West on RT. 322, after you pass the traffic light for Wal-Mart/Sam's Club, look for and follow signs to I-83 North, once on I-83 North, stay in far right lane, get off at Exit 29 Union Deposit Road (William Nesbit's home is about 2.5 miles East). At top of exit ramp, turn right, you are now on Union Deposit Road, move to the center or left lane, go past the Point Mall, go straight at traffic light (Sunoco Station on right), go straight at next traffic light (past Turkey Hill mini-mart), 5760 is about 0.9 miles after the traffic light and is on your left at the large evergreen trees, the house sits back about 150 feet from Union Deposit Road and has parking for about 6 to 8 vehicles, home is across from Jehovah's Witnesses Church (*permission has been granted to use their parking lot*), if you drive past the VFW, then you have just passed 5760. Turn around at Fairmont Drive (*first street on left*) about 0.2 miles. *I do not recommend using the first street on the right as it is difficult to see on coming traffic in order to make the left hand turn, back to 5760.*



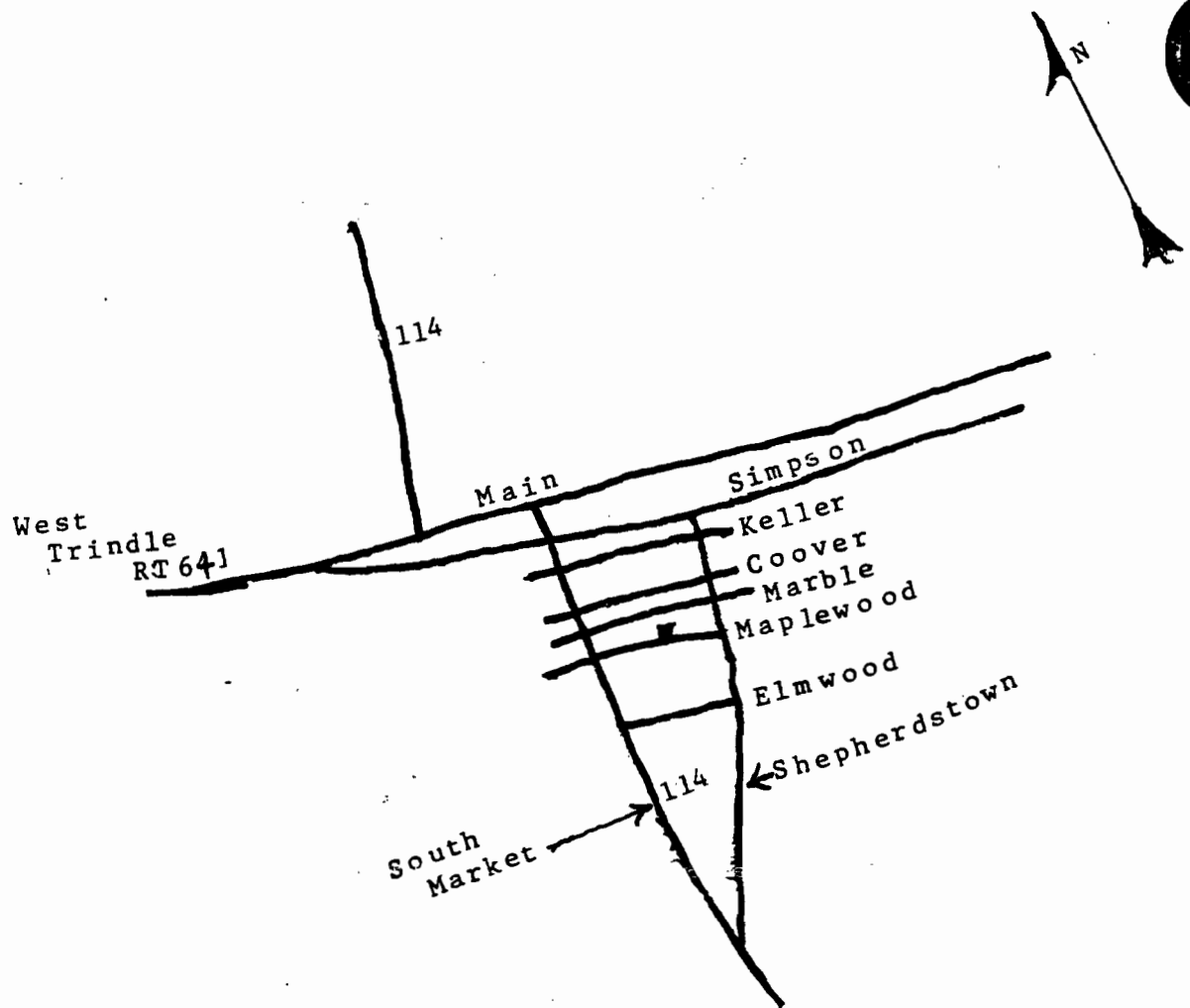

John "Jack" Kennedy  
 113 East Maplewood Ave  
 Mechanicsburg, PA 17055  
 (717) 766-9522

NMRA #047736

Jack's Mt. Holly and Mechanicsburg Railroad is a freelanced bridge line in Cumberland County, PA. Both steam and diesel, leased from the PRR, move the tonnage across the line. Scenery is 90% complete on this 24' by 24' HO scale layout. All motive power on this railroad is controlled by Zero 1 command control. The Zero 1 is a carrier control system which permits locomotives to run independently of each other without the need of separate electrical blocks. Jack has modeled a full block of structures that recreates a section of Mechanicsburg.

Jack is the holder of NMRA Achievement Program certificates in Golden Spike, Volunteer, and Scenery.



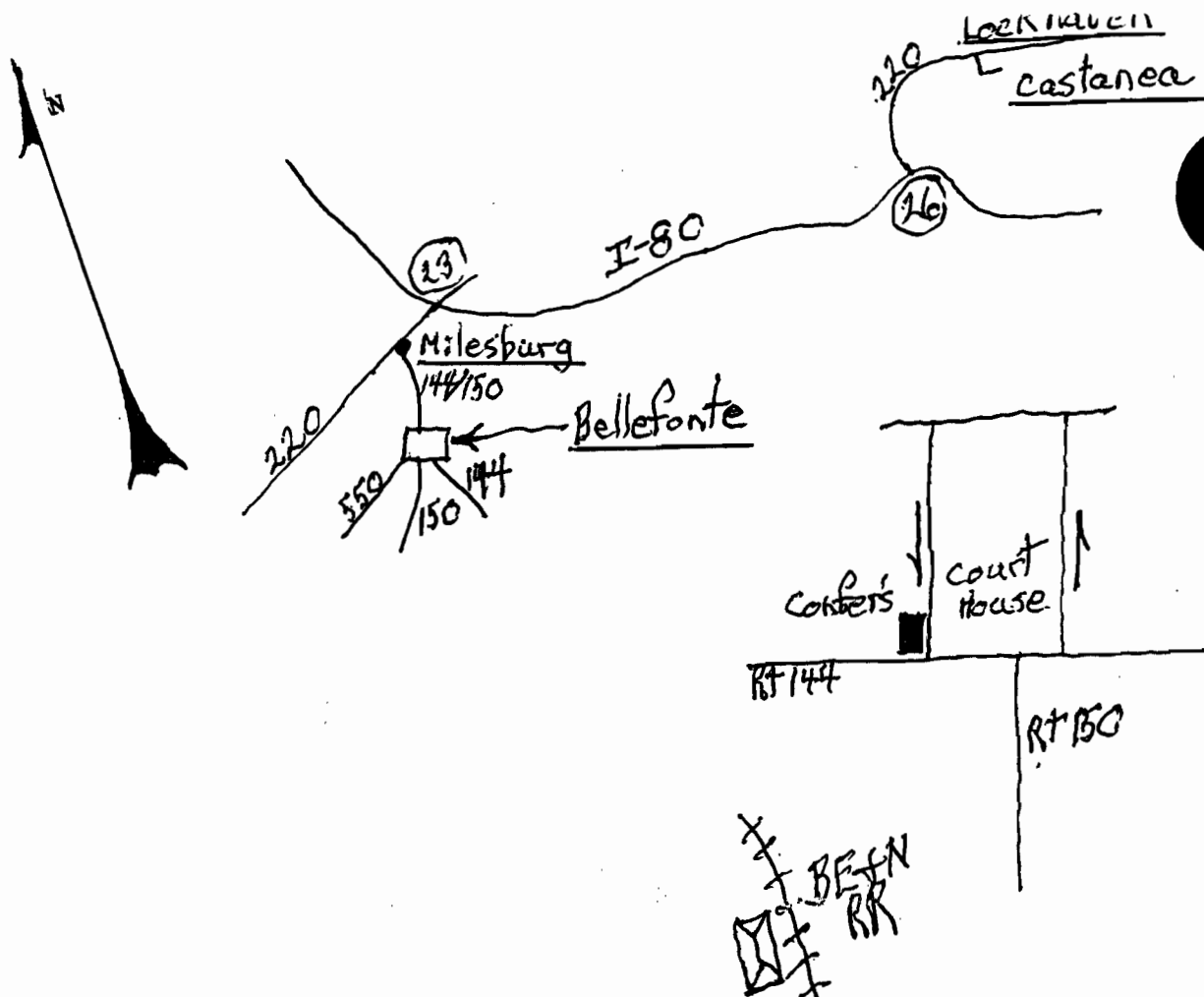

**Nittany Valley Model Railroad Club  
100 North Allegheny Street  
below Confer's Jewelers  
Bellefonte, PA 16823**

The Nittany Valley Model Railroad Club is a fully scenicked HO scale layout, below Confer's Jewelers across from the Court House in Bellefonte. This layout is designed to be operated in the entire space available. There is not much meeting space and it is not handicapped equipped.

The Susquehanna Division #11, will hold its meeting and clinics at the Clinton Central Railroad, outside of Lockhaven, in Castanea.

**Directions:** From the South take RT 150, to the intersection with RT 144 (Allegheny Street). This is the center of Bellefonte, Confer's Jewelers is next to the Court House. [Note: The gold colored parking meters are for a maximum of 15 minutes, do not use them, also, do not use the parking lot on top of the hill, it is for the prison only.] From the North, I-80 exit #23, at Milesburg, RT 220 South to RT 144 South to Bellefonte. RT 144 is N. Allegheny Street, Confer's Jeweler's is #100.

Bellefonte is also home to the Bald Eagle and Northern Railroad, who operates out of a former PRR station 3 blocks South of the Nittany Valley Model Railroad Club. The Bald Eagle and Northern has an N scale layout in the station. They also have excursions powered by some of the last remaining RDC cars.

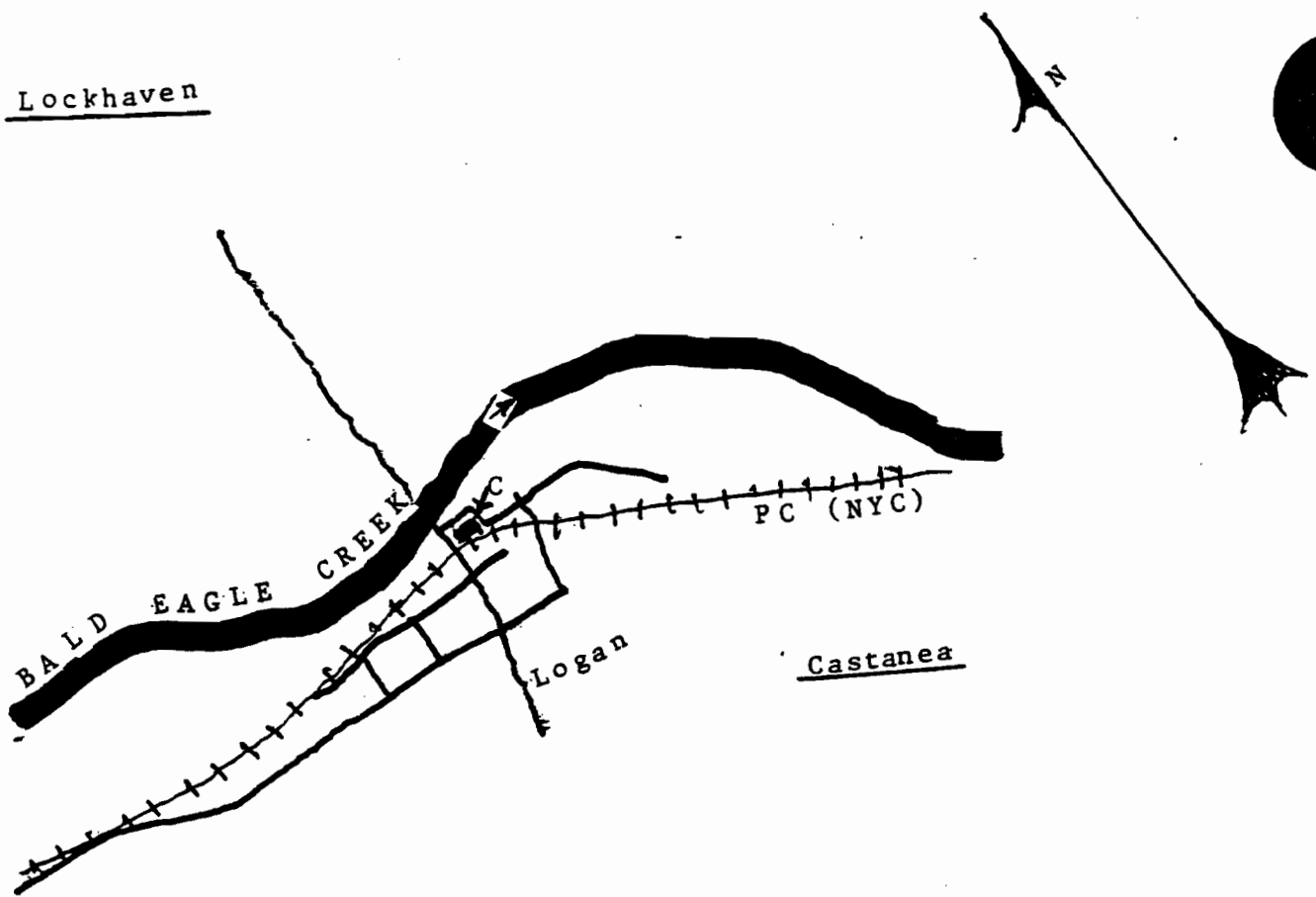

**Clinton Central Model Railroad Club**  
**15 Logan Ave**  
**Castanea, PA 17726**  
**An NMRA Member #109769**  
**Contact: John Gromley (717) 398-0698**

**The Clinton Central Model Railroad is located inside the Castanea, New York Central railroad station, just 3/4 miles South of Lockhaven, PA. They are open at 7:00 PM, on Tuesday evenings.**

**The club became a member of the NMRA in the Fall of 1996, holds an NMRA Golden Spike Award, and has an operational partially scenicked HO scale layout.**

**The interior of the station has many railroad artifacts and a reference library. The club also has HO scale private road name box cars for sale.**

**The club location is marked by a "C" with an arrow on the map.**

# Susquehanna Division 11 Membership Application

*Mid-Eastern Region, National Model Railroad Association, Inc.*

The Susquehanna Division is located in the central portion of Pennsylvania. Counties covered are: Adams, Berks, Blair, Cambria, Carbon, Centre, Clinton, Columbia, Cumberland, Dauphin, Huntingdon, Juniata, Lackawanna, Lancaster, Lebanon, Lycoming, Lehigh, Luzerne, Lycoming, Mifflin, Monroe, Montour, Northumberland, Perry, Pike, Schuylkill, Sullivan, Susquehanna, Snyder, Union, Wayne, Wyoming, and York. Anyone interested in the hobby may become a member of the Division regardless of their place of residence. A **Regular Member** must be a member in good standing of both the MER and the NMRA and must provide the MER and NMRA membership numbers to Division 11 for verification. All others may become a **Subscriber** of the Division 11 newsletter only. Annual dues for the Susquehanna Division are **\$2.00** which includes the quarterly newsletter. Among the activities of the Division are the semi-annual mini-conventions held in the spring and fall. A quarterly newsletter, the *Susquehanna Sidetracks*, is published with the Division schedule of events and other model railroad news.

Type of application: New  Renewal  Change of Address

Primary Scale:  Layout?  Interests: Modules  Narrow Gauge  Traction  SIG

Name: \_\_\_\_\_ NMRA# \_\_\_\_\_ MER# \_\_\_\_\_

Address: \_\_\_\_\_

Phone: H ( ) \_\_\_\_\_ W ( ) \_\_\_\_\_ E-Mail Address \_\_\_\_\_

Return completed application, with a check payable to: *Susquehanna Division*, 1709 West Market Street, York, PA 17404

Rev 12/96-00

